

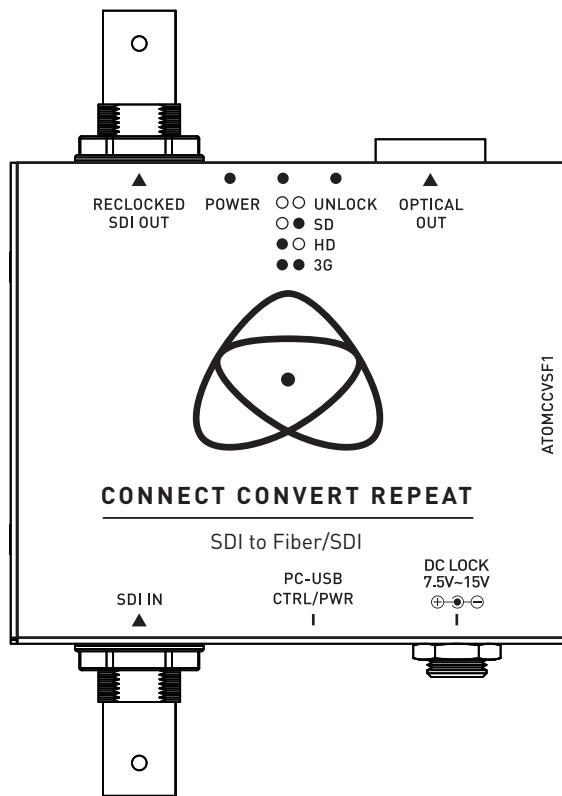

ATOMCCV-SF1

CONNECT CONVERT REPEAT

SDI TO FIBER/SDI



APPROX. SIZE

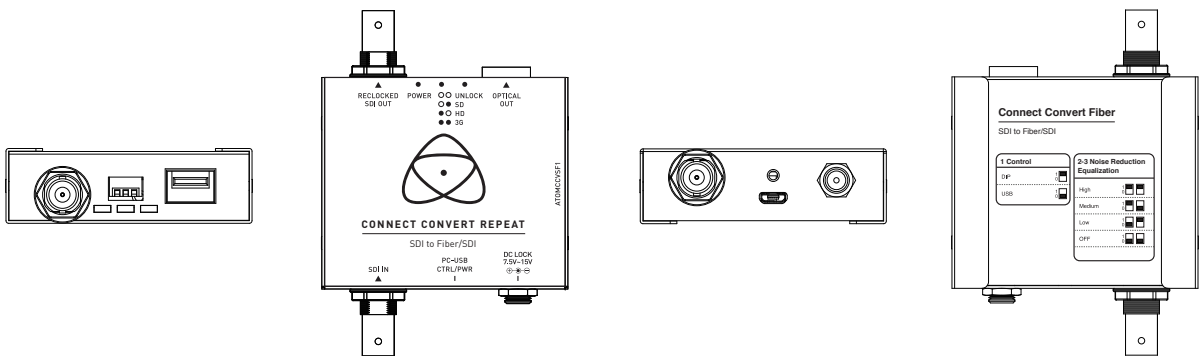

CONNECT CONVERT REPEAT

SDI TO FIBER/SDI

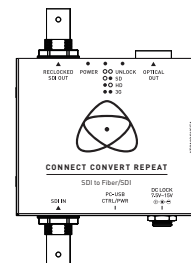

CONNECT CONVERT REPEAT SDI TO FIBER/SDI	
FEATURES	Multi-Standard support (3G/HD/SD-SDI)
	Up to 10KM Transmission with Single Mode Optical Fiber
	Single Channel SFP included with LC Type Connector
	Interchangeable Modular Design for Longer Cable Reach or Different Connector Type
	Low operating Temperature
	1 Year Warranty - Upgradeable to 3 Years on Registration
	DC or USB powerable
	Detachable Rack Ears
PHYSICAL FEATURES	Firmware Upgradeable Through Micro-USB Port
	74mm x 22mm x 63.6mm (W x H x D)
	104mm (W inc. detachable rack ears)
	193.4g (single unit)
	215.6g (inc. detachable rack ears)
INPUT INTERFACE	22.2g (detachable rack ears only)
	BNC SDI x 1
OUTPUT INTERFACE	LC Type Connector for Single-Mode Optical Fiber Cablex1
	Support Wavelength : 1310nm
	BNC SDI x 1
SUPPORTED VIDEO INPUT FORMAT	SD -SDI
	720×480i 60fps
	720×576i 50fps
	HD-SDI
	1920×1080p 24/25/30fps
	1920×1080i 50/60fps
	1280×720p 50/60fps
	3G -SDI
1920×1080p 50/60fps	
SUPPORTED VIDEO OUTPUT	LC Fiber : As Input SDI Format
	SDI : As Input SDI Format
AUDIO INPUT FORMAT	Up to 16 Channels, 24bit, 48KHz
AUDIO OUTPUT FORMAT	Up to 16 Channels, 24bit, 48KHz
DC INPUT VOLTAGE	7.5V - 15V DC (Barrel Connector, 5.5mm, 2.1mm Center)
OPERATING TEMPERATURE	0° C to 50° C (32° F to 122° F)